

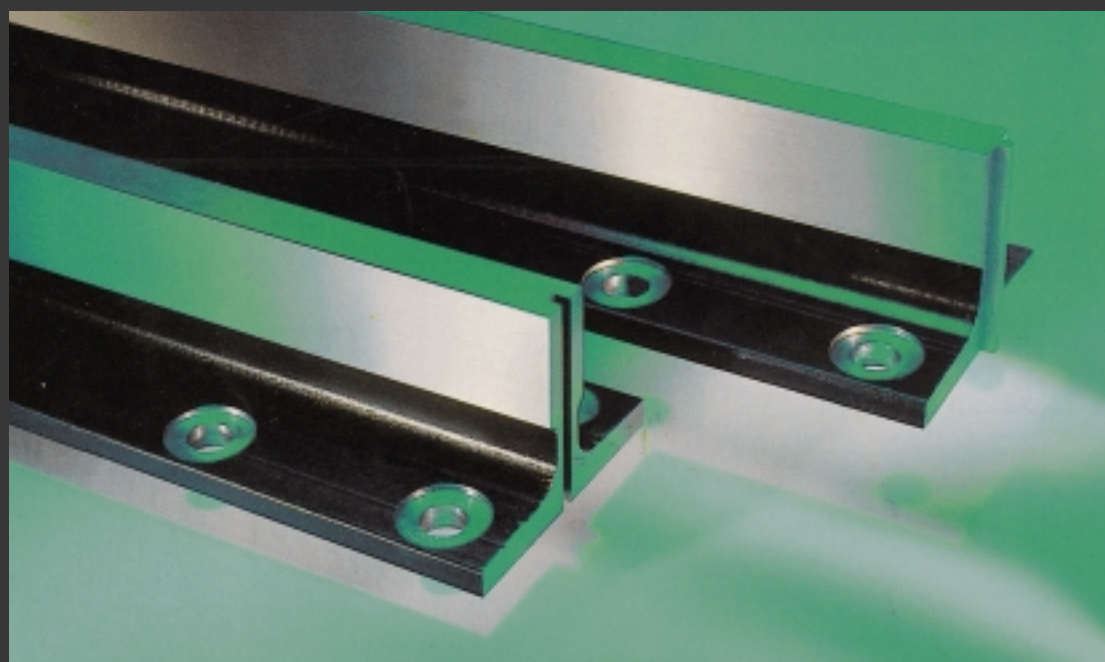

World Guide Rail Alliance



s p e c i f i c a t i o n s

High Quality Guide Rails

Italy

Monteferro S.p.A.
Via Como, 11
21020 Monvalle (Varese)
Phone +39 0332 798879
Fax +39 0332 971016
E-mail: customer.service@monteferro.it

Czech Republic

Monteferro Hradek A.S.
33842 Hradek
Nova Hut 204
Phone +420 371 725467
Fax +420 371 725477
E-mail: customer.service@monteferro.cz

Monteferro Spain

Poligono Industrial De Jundiz
C./Landalucia, 20
01015 Vitoria-Gasteiz
Phone +34 945 292260
Fax +34 945 292264

Canada/USA

Monteferro America
2840 Wenzel Street
Box J1 Birds Hill R.P.O.
East St. Paul, Manitoba
Canada R2E 1H3
Phone +1 204 2220247
Fax +1 204 2244175
E-mail: sales@monteferroamerica.com

Brazil

Monteferro América Latina L.T.D.A.
Rua Torre Eiffel, 127 - RioCotia
Cotia - Sao Paulo
CEP 06705 - 481
Phone +55 11 41482575
Fax +55 11 41482575
E-mail: monteferro@monteferro.com.br

Hong Kong

Monteferro Pacific Trading Ltd.
Unit 19, 6/F., New Mandarin Plaza Tower A
14 Science Museum Road
Tsimshatsui East, Kowloon
Phone +852 25214225
Fax +852 25261393
E-mail: customer.service@monteferro.com.hk

China

Habei Monteferro Guide Rails Co., L.T.D.
No. 24 Nanhuan Zhong Road
Cangzhou, Hebei
P.C.: 061001
Phone +86 317 2029504
Fax +86 317 2026327
E-mail: montefer@heinfo.net

Printed in Italy

Subject to modification without prior notice

High Quality Guide Rails



Reference Norm: ISO 7465: 1997(E) - Raw material: E 275 B (ISO 630: 1995), corresponding to Fe 430 B
 Guide rail length: 5,000 mm ± 2mm. Different length according to Customer's requirements
 Different guide rails sections and specifications: according to definition with Customers

Dimensions

Monteferro Code	ISO Code	b ₁ mm	h ₁ mm	h mm	k mm	n mm	c mm	g mm	f mm	r _s mm	m ₁ mm	m ₂ mm	t ₁ mm	t ₂ mm	l mm	d mm	d ₁ mm	b ₃ mm	l ₂ mm	l ₃ mm	
Tolerances		±1,5	±0,75	±0,05	+0,05/-0	+3/0		±0,75	±0,75		+0,03/-0	+0/-0,03	±0,1	±0,1	+3/0				±0,2	±0,2	±0,2
RP 75 H	T 75-3/BE	75	62	61	10	30	8	7	9	3	3	2,95	3,5	3	123	13	26	43	90	30	
RP 78 H	---	78	56	55	10	26	7	6	8,5	3	3	2,95	3,5	3	123	13	26	43	90	30	
RP 82 H	T 82/BE	82,5	68,25	66,6	9	25,4	7,5	6	8,25	3	3	2,95	3,5	3	111	13	26	50,8	81	27	
RP 89 H	T 89/BE	89	62	61	15,88	33,4	10	7,9	11,1	3	6,4	6,37	7,14	6,35	156	13	26	57,2	114,3	38,1	
RP 90 H	T 90/BE	90	75	74	16	42	10	8	10	4	6,4	6,37	7,14	6,35	156	13	26	57,2	114,3	38,1	
RP 114 H	---	114	88,9	88	15,88	38	9,5	7,9	11,1	4	6,4	6,37	7,14	6,35	156	17	33	79,4	114,3	38,1	
RP 125 H	T 125/BE	125	82	81	16	42	10	9	12	4	6,4	6,37	7,14	6,35	156	17	33	79,4	114,3	38,1	
RP 127-1 H	T 127-1/BE	127	88,9	88	15,88	44,5	10	7,9	11,1	4	6,4	6,37	7,14	6,35	156	17	33	79,4	114,3	38,1	
RP 127-2 H	T 127-2/BE	127	88,9	88	15,88	50,8	10	12,7	15,9	5	6,4	6,37	7,14	6,35	156	17	33	79,4	114,3	38,1	
RP 127-2 C 14H	---	127	88,9	88	15,88	50,8	14	12,7	15,9	5	6,4	6,37	7,14	6,35	156	17	33	79,4	114,3	38,1	
RP 140-1 H	T 140-1/BE	140	108	107	19	50,8	12,7	12,7	15,9	5	6,4	6,37	7,14	6,35	193	21	40	92,1	152,4	31,8	
RP 140-2 H	T 140-2/BE	140	102	101	28,6	50,8	17,5	14,5	17,5	5	6,4	6,37	7,14	6,35	193	21	40	92,1	152,4	31,8	
RP 140-3 H	T 140-3/BE	140	127	126	31,75	57,2	19	17,5	25,4	5	6,4	6,37	7,14	6,35	193	21	40	92,1	152,4	31,8	

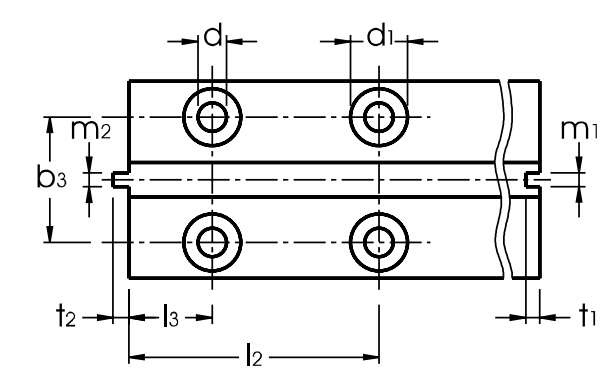
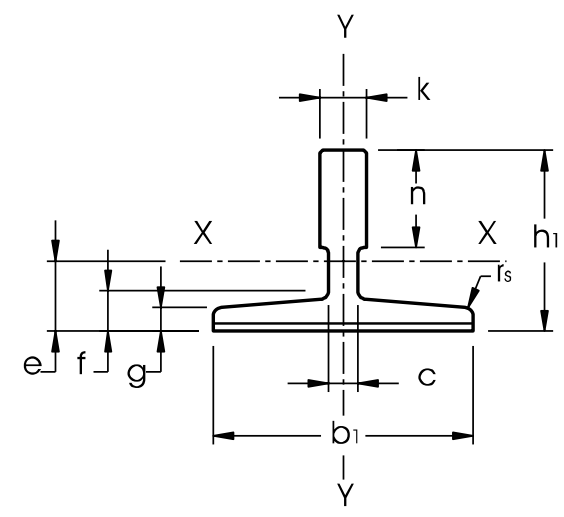

Key Factors

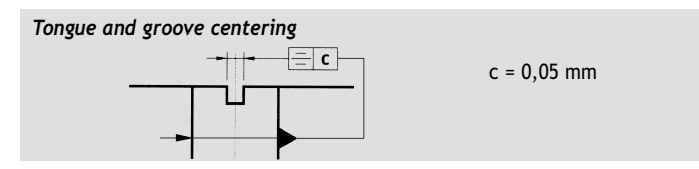
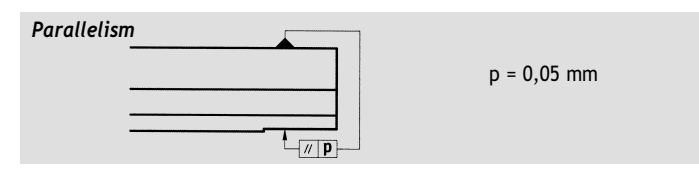
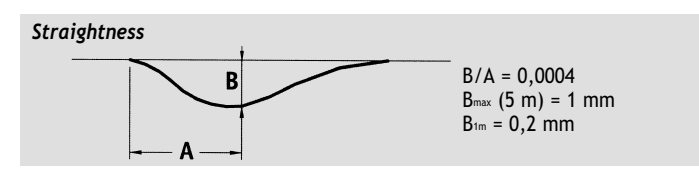
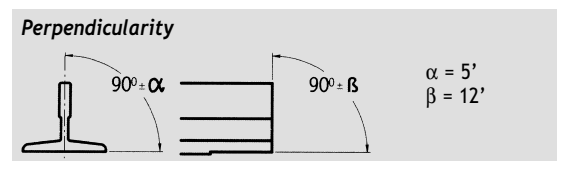
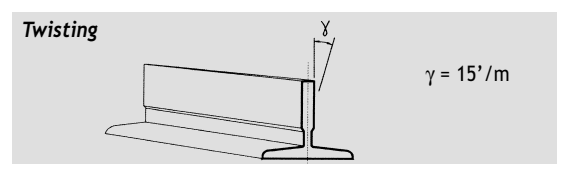
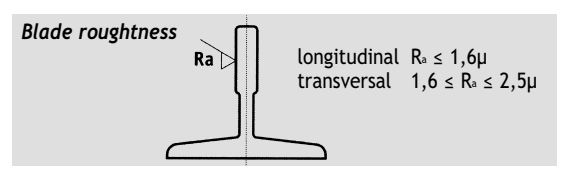

Technical Characteristics

Monteferro Code	ISO Code	S cm ²	q ₁ kg/m	e cm	I _{xx} cm ⁴	W _{xx} cm ³	i _{xx} cm	I _{yy} cm ⁴	W _{yy} cm ³	i _{yy} cm
RP 75 H	T 75-3/BE	10,99	8,63	1,86	40,35	9,29	1,92	26,49	7,06	1,55
RP 78 H	---	9,84	7,72	1,65	29,9	7,56	1,47	26,1	6,71	1,63
RP 82 H	T 82/BE	10,9	8,55	1,98	49,4	10,2	2,13	30,5	7,4	1,67
RP 89 H	T 89/BE	15,7	12,3	2,02	59,52	14,25	1,95	52,4	11,8	1,83
RP 90 H	T 90/BE	17,25	13,55	2,61	102	20,87	2,43	52,6	11,8	1,75
RP 114 H	---	20,85	16,37	2,87	179	29,7	2,93	108	19,1	2,29
RP 125 H	T 125/BE	22,83	17,9	2,43	151	26,2	2,57	159	25,4	2,64
RP 127-1H	T 127-1/BE	22,64	17,77	2,75	186,2	30,4	2,87	148	23,4	2,56
RP 127-2H	T 127-2/BE	28,63	22,48	2,47	198,4	30,9	2,63	230	36,2	2,83
RP 127-2c14H	---	29,53	23,18	2,5	198,8	31,1	2,59	229,6	36,2	2,78
RP 140-1H	T 140-1/BE	35,2	27,6	3,24	404	53,4	3,39	310	44,3	2,97
RP 140-2H	T 140-2/BE	43,22	33,92	3,47	457	68	3,25	358	51,2	2,88
RP 140-3H	T 140-3/BE	58,57	46	4,38	953	114,6	4,03	486	69,4	2,88